

SWAGE "T" TERMINAL

316 STAINLESS STEEL



Import



Drop
Forged



Precision
Machined

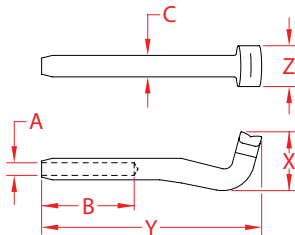

ITEM	A (wire)	B	C BEFORE (swage)	C AFTER (swage)	X (height)	Y (length)	Z (width)	WT (lb)	PACKAGING TYPE	EACH (qty)	INNER (qty)	CARTON (qty)	UPC
S0742-0002	3/32"	1.26"	0.22"	0.19"	0.70"	3.25"	0.58"	0.04	POLYBAG	1	10	500	791506050261
S0742-0003	1/8"	1.53"	0.25"	0.22"	0.80"	3.32"	0.61"	0.05	POLYBAG	1	10	500	791506050278
S0742-0004	5/32"	1.77"	0.30"	0.25"	0.90"	3.90"	0.66"	0.07	POLYBAG	1	1	20	791506050285
S0742-0005	3/16"	2.05"	0.36"	0.31"	1.10"	4.39"	0.73"	0.12	POLYBAG	1	5	200	791506050292
S0742-0006	7/32"	2.28"	0.43"	0.38"	1.40"	5.17"	1.09"	0.30	POLYBAG	1	5	100	791506050308
S0742-0007	1/4"	2.52"	0.49"	0.44"	1.35"	4.29"	1.08"	0.29	POLYBAG	1	5	100	791506050315
S0742-0008	9/32"	2.79"	0.56"	0.50"	1.65"	5.71"	1.20"	0.40	POLYBAG	1	1	75	791506050322
S0742-0009	5/16"	3.03"	0.64"	0.56"	1.95"	7.14"	1.37"	0.66	POLYBAG	1	1	50	791506050339
S0742-0010	3/8"	3.80"	0.71"	0.63"	2.00"	8.00"	1.40"	0.88	POLYBAG	1	1	25	791506050346

NOTE:
ALL DIMENSIONS ARE NOMINAL (+/- 3%) AND ARE SUBJECT TO CHANGE WITHOUT NOTICE.